

# Banyan Tree MAYAKOBA

Riviera Maya



BANYAN TREE  
— MAYAKOBA —

*Sanctuary for the Senses*

An extraordinary blend of Mexican culture and Asian hospitality

# LOCATION

Riviera Maya, Mexico



- Located in the Riviera Maya, in the beautiful Yucatan Peninsula
- 40 minutes from Cancun International Airport and 10 minutes of Playa del Carmen



BANYAN TREE  
— MAYAKOBA —

BANYANTREE.COM

# MAYAKOBA

The Venice of the Riviera Maya



- Natural and sustainable 600-acre oasis of mangrove, beach and fresh canals.
- The most exclusive complex in the Riviera Maya
- Integrated resort community including “El Camaleón” golf course: a Greg Norman design, home to the only PGA Tour event in Latin America and the Jim McLean Golf School



BANYAN TREE  
— MAYAKOBA —

BANYANTREE.COM

# MAYAKOBA MAP

Riviera Maya, Mexico



BANYAN TREE  
— MAYAKOBA —

# MAIN LOBBY AREA

Luxury, nature and serenity in exquisite harmony

“The first Banyan Tree property in the Americas”

Mayakoba – meaning *village over the water* in Maya – is a harmonious mixture of Mexican culture with subtle Asian finishes, no detail is overlooked.

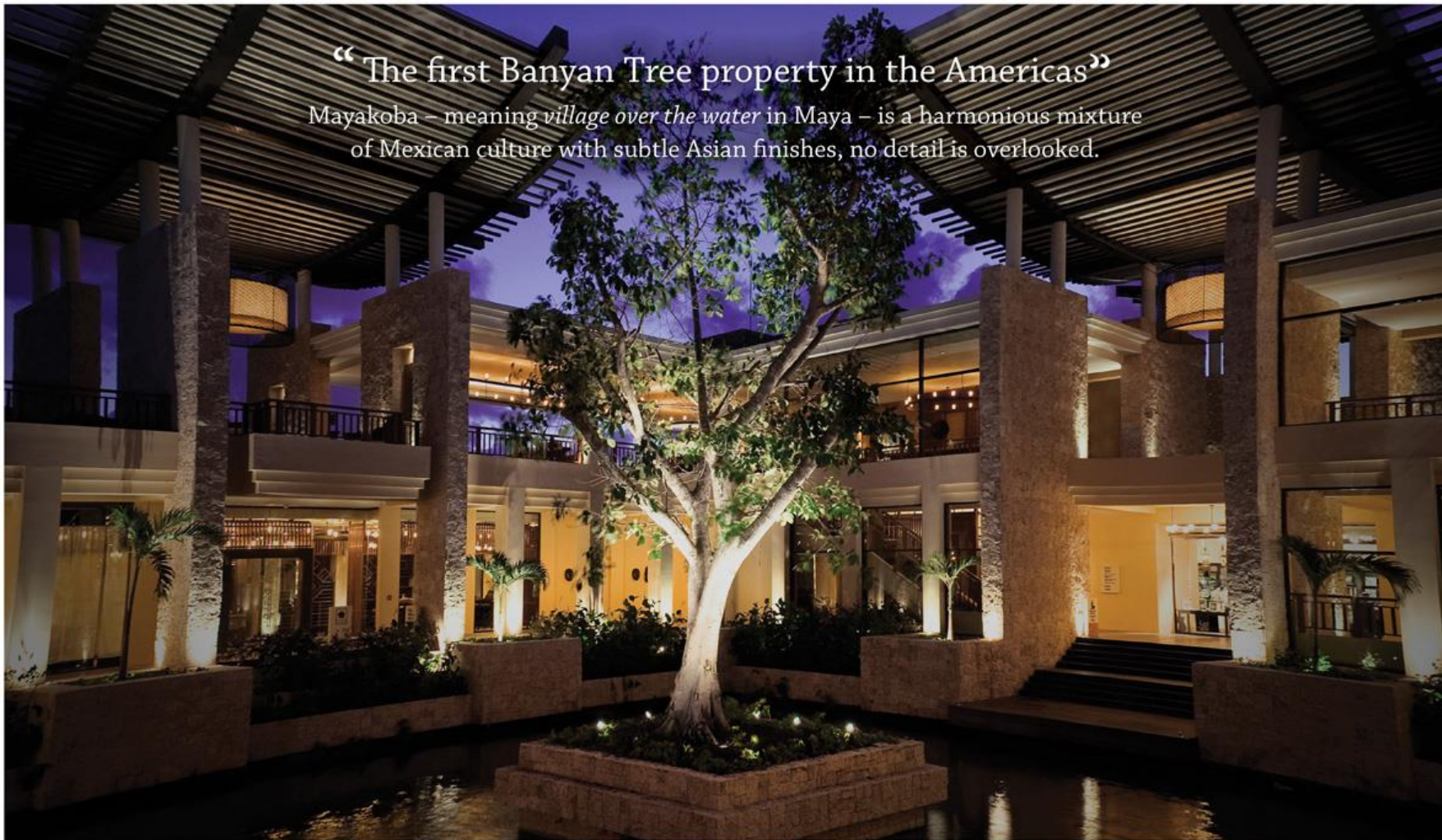

BANYAN TREE  
— MAYAKOBA —

BANYANTREE.COM



## LEGEND

### VILLA

- Bliss Pool Villa
- Serenity Pool Villa
- Spa Pool Villa
- Serenity Two-Bedroom Pool Villa
- Two-Bedroom Pool Villa at The Haven
- Ocean Front Three-Bedroom Pool Villa at The Haven
- Three-Bedroom Pool Family Residence

### DINING FACILITIES

- A Tamarind Restaurant
- B La Copa, Lobby Bar (UPPER LEVEL)
- C La Cava Wine Cellar
- D Oriente Restaurant
- E Reflections Pool Bar
- F Saffron Restaurant
- G Sands Restaurant
- H Haab' Maya Dining Experience
- I The Tomahawk Den Steakhouse
- J The Beach Shack

### FACILITIES

- A Front Desk (UPPER LEVEL)
- B Banyan Tree Gallery
- C Meeting Rooms
- D Rainforest Spa
- E Spa Reception
- F Fitness Centre
- G Beauty Salon
- H Spa Pavilions
- I Business Centre
- J Reflections Pool
- K Beach Club
- L MK Blue
- M Eco Trail Access



BANYAN TREE  
— MAYAKOBA —



BANYAN TREE  
— MAYAKOBA —

# ACCOMMODATIONS

118 elegantly designed private and comfortable villas

## CATEGORY

Bliss Pool Villa

Serenity Pool Villa

Spa Pool Villa

Serenity Two Bedroom Pool Villa

Two Bedroom Pool Villa at the Haven

Oceanfront Three Bedroom Pool Villa

Three-Bedroom Family Residence

## VILLAS

45

25

08

07

04

06

23

## SIZE

293 m<sup>2</sup> / 3,153 sq.ft.

322 m<sup>2</sup> / 3,466 sq.ft.

322 m<sup>2</sup> / 3,466 sq.ft.

512 m<sup>2</sup> / 5,511 sq.ft.

512 m<sup>2</sup> / 5,511 sq.ft.

512 m<sup>2</sup> / 5,511 sq.ft.

256 m<sup>2</sup> / 2,755 sq.ft.



BANYAN TREE  
— MAYAKOBA —

BANYANTREE.COM

# BLISS POOL VILLA

Step into your own private oasis



No. of Villas: 45  
Size: 293 m<sup>2</sup> / 3,153 sq.ft.  
Floors: 1  
Max. Occupancy: 2 persons

 FLOOR PLAN



BANYAN TREE  
— MAYAKOBA —

BANYANTREE.COM

# SERENITY POOL VILLA

Blissful retreat and ideal space to relax with your couple



No. of Villas: 25  
Size: 322 m<sup>2</sup> / 3,466 sq.ft.  
Floors: 1  
Max. Occupancy: 2 persons

 FLOOR PLAN



BANYAN TREE  
— MAYAKOBA —

BANYANTREE.COM

# SPA POOL VILLA

The perfect romantic and rejuvenating hideaway



No. of Villas: 8  
Size: 322 m<sup>2</sup> / 3,466 sq.ft.  
Floors: 2 / Outdoor spa treatment room  
Max. Occupancy: 2 persons

 FLOOR PLAN



BANYAN TREE  
— MAYAKOBA —

BANYANTREE.COM

# SERENITY TWO-BEDROOM POOL VILLA & TWO-BEDROOM POOL VILLA AT THE HAVEN



No. of Serenity Two-Bedroom Pool Villas: 7  
No. of Two-Bedroom Pool Villas at the Haven: 4  
Size: 512 m<sup>2</sup> / 5,511 sq.ft.  
Floors: 2 Max. Occupancy: 4 persons

 FLOOR PLAN



BANYAN TREE  
— MAYAKOBA —

BANYANTREE.COM

# OCEAN FRONT THREE-BEDROOM POOL VILLA AT THE HAVEN

Sleek, contemporary and open, perfect for families and beach lovers



No. of Villas: 6  
Size: 512 m<sup>2</sup> / 5,511 sq.ft.  
Floors: 2 / Beach Front  
Max. Occupancy: 6 persons

 FLOOR PLAN



BANYAN TREE  
— MAYAKOBA —

BANYANTREE.COM

# THREE-BEDROOM FAMILY RESIDENCE

Designed for families and friends, secluded spaces surrounded by lush nature



No. of Villas: 23  
Size: 256 m<sup>2</sup> / 2,755 sq.ft.  
Floors: 3 / Golf course view  
Max. Occupancy: 6 persons

 FLOOR PLAN



BANYAN TREE  
— MAYAKOBA —

BANYANTREE.COM

# CULINARY EXPERIENCES

## ORIENTE

- International buffet breakfast 7:00 am – 11:30 am
- Lunch 11:30 am – 5:00 pm



## TOMAHAWK NIGHT

3 times per week  
for dinner in Oriente  
6:00 -11:00 pm



## SANDS

- Open 11:00 am – 5:00 pm



*Sands*



BANYAN TREE  
— MAYAKOBA —

# CULINARY EXPERIENCES

## TAMARIND

- Techniques and international sublime flavors
- Dinner: 6:00 - 11:00 pm



## SAFFRON

- Authentic thai cuisine
- Unrivalled experience
- Dinner: 6:00 - 11:00 pm



BANYAN TREE  
— MAYAKOBA —

BANYANTREE.COM

# CULINARY EXPERIENCES

## LA COPA

- Bar & tapas
- Open from 12:00 pm - 1:00 am



LA COPA  
Lobby Lounge



## LA CAVA

- Private events for up to 12 people



BANYAN TREE  
— MAYAKOBA —

# CULINARY EXPERIENCES

## REFLECTIONS

- Pool Pampering service
- Lunch & Bar: 11:00 am - 5:00 pm



## SANDS BEACH CLUB

- Access by foot, bicycle, boat or golf cart
- Pool Bar
- Water Activities
- Pool Pampering Service



BANYAN TREE  
— MAYAKOBA —

BANYANTREE.COM

# HAAB'

## A Maya Dining Experience

A deep-in-the-jungle mystical experience featuring the four sacred elements of water, earth, wind and fire, where you can relive the superb culinary arts of the ancient Maya civilization.

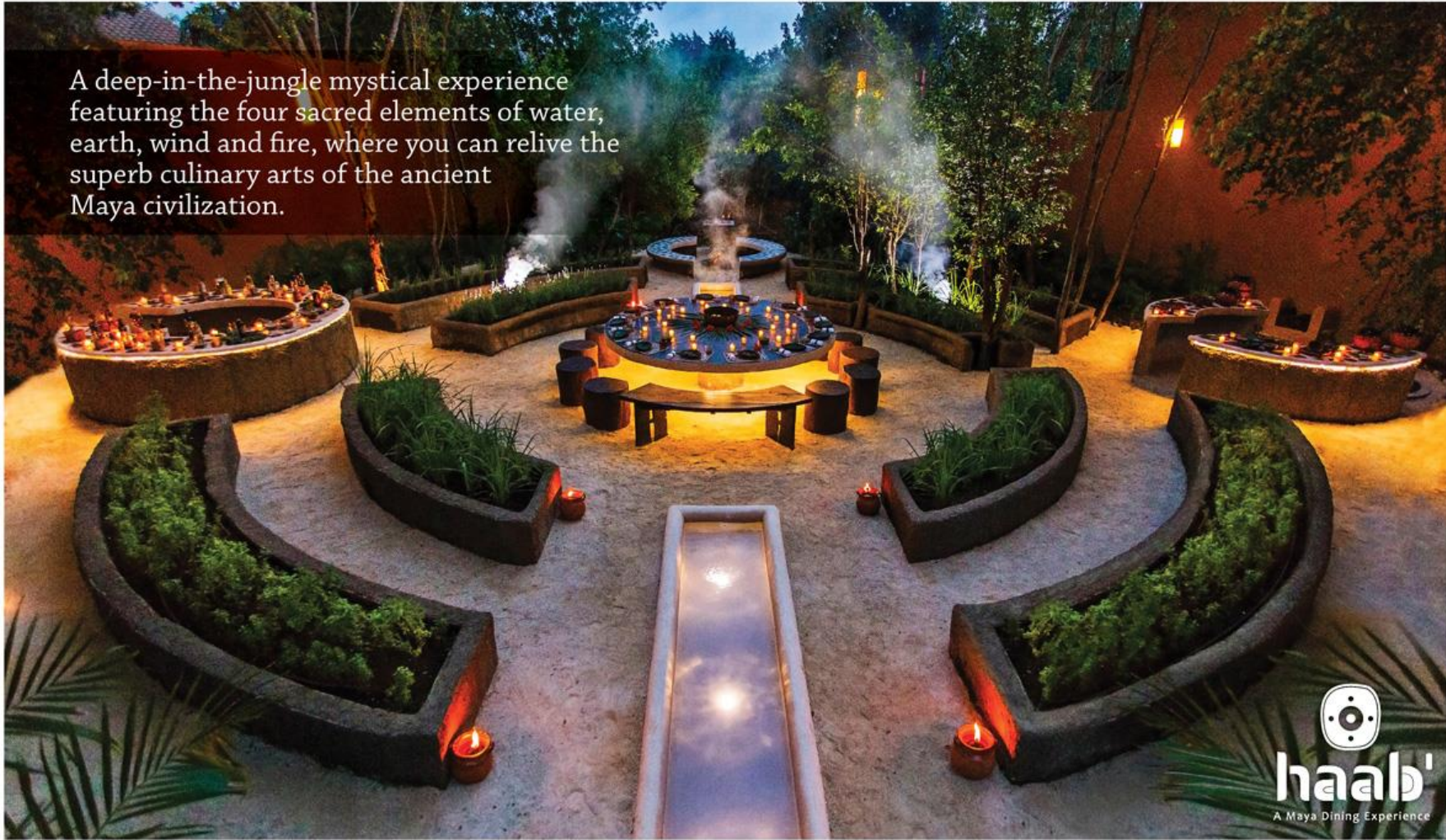

**haab'**  
A Maya Dining Experience



BANYAN TREE  
— MAYAKOBA —

BANYANTREE.COM

# CULINARY EXPERIENCES

## IN-VILLA DINING

Experience invigorating breakfasts and magnificent evenings in the privacy and comfort of your private villa. Our Chefs will set up sumptuously exotic meals and romantic poolside barbeques.



## TAPAS CRUISE

Enjoy magnificent toasts and tapas as you sail through the natural waterways and canals of Mayakoba.



BANYAN TREE  
— MAYAKOBA —

BANYANTREE.COM

# IXCHEL

## Romantic Dining Cruise

'Goddess of the Moon', Ixchel is our traditional and unique trajinera or dining boat, with the finest cuisine prepared by one of our culinary hosts.

*Ixchel*



BANYAN TREE  
— MAYAKOBA —

BANYANTREE.COM

# CULINARY EXPERIENCES

## THE BEACH SHACK

Refreshing daiquiris, margaritas and cold beers to enjoy under the sun on the warm sandy beaches of Mayakoba.



## CATCH OF THE DAY

Choose the best fresh fish coming straight from the sea as you interact with our fishermen and chefs to customize it to your particular taste. To be enjoyed either on the beach, in the comfort of your villa or at one of our restaurants.



BANYAN TREE  
— MAYAKOBA —

BANYANTREE.COM

# BANYAN TREE SPA

Travel + Leisure's number #1 Spa in Mexico



BANYAN TREE  
SPA  
MAYAKORA



- 16 private Spa Pavilions with deluxe amenities such as sauna, bathtub, Rainmist shower and more.
- Signature spa treatments inspired by traditional Thai therapies.
- Uniquely and trained therapists, the highest quality treatments from the Banyan Tree Spa Academy in Phuket.
- Opening hours: from 10:00 am to 10:00 pm, daily.



BANYAN TREE  
— MAYAKORA —

BANYANTREE.COM

# THE RAINFOREST

A new dimension of holistic rejuvenation



- *The Rainforest*, an invigorating, state-of-the-art hydrothermal voyage.
- 8 different therapy experiences for cleansing, detoxification, conditioning and relaxation.



BANYAN TREE  
— MAYAKOBA —

BANYANTREE.COM

# MEETINGS AND EVENTS

“Inspiring, stimulating, spectacular, unforgettable”

Words that timidly describe group experiences  
at Banyan Tree Mayakoba



BANYAN TREE  
— MAYAKOBA —

BANYANTREE.COM

# EVENTS

## Locations

### MAYAPAN GARDEN

Celebrate a special event with natural surroundings in our mystical garden.



### EL PUEBLITO

Located in the heart of Mayakoba, "El Pueblito", it has been designed like a real Mexican village, enhancing the traditions in the perfect setting for any event.



### MK BLUE

Exudes a warm atmosphere and is suitable for a variety of events.



BANYAN TREE  
— MAYAKOBA —

BANYANTREE.COM

# BALLROOMS



## *Mayapan*

- Dimensions: 3,310 Sq. ft.
- Ceiling height: 21.30 ft
- Maximum number of delegates: 250

## *Sayil*

- Dimensions: 1,356 Sq. ft.
- Ceiling height: 12.50 ft
- Maximum number of delegates: 100



## *Labna*

- Dimensions: 470 Sq. ft.
- Ceiling height: 10.50 ft
- Maximum number of delegates: 30

## *Kabah*

- Dimensions: 486 Sq. ft.
- Ceiling height: 10.50 ft
- Maximum number of delegates: 30



BANYAN TREE  
— MAYAKOBA —

BANYANTREE.COM

# DESTINATION WEDDINGS



*For that special day*  
Uncover unique settings within the  
sublime beauty of Mayakoba.



BANYAN TREE  
— MAYAKOBA —

BANYANTREE.COM

# INTIMATE MOMENT

Our team of Romance  
ready to surprise



BANYAN TREE  
— MAYAKOBA —

[BANYANTREE.COM](http://BANYANTREE.COM)

# OUTDOOR ACTIVITIES & FITNESS



- Fitness center – 24 hours - Complimentary access
- Bicycles (subject to availability & extra charge)
- Eco-tour on boat throughout mangroves & canals
- Sands Beach Club
- Kids Club
- Tennis and racquetball courts
- Archery
- Kayaks



BANYAN TREE  
— MAYAKOBA —

BANYANTREE.COM

# GOLF

## Resort Experiences



- Designed by the legendary Greg Norman, 18 hole, par 72 Championship Golf Course
- Home of the OHL Classic at Mayakoba, an official PGA TOUR event
- The only Jim McLean Golf School in Mexico
- Redesigned Club House and Koba restaurant



BANYAN TREE  
— MAYAKOBA —

BANYANTREE.COM

# STAY FOR GOOD

One of the most sustainable luxury resorts in the Caribbean



Banyan Tree Mayakoba is committed to creating a positive impact to our surrounding environment and guests. We are EarthCheck Silver Certified, PROFEPA Tourism Environmental Quality Certified and a Rainforest Alliance Sustainable Standard-Setter Award winner.



BANYAN TREE  
— MAYAKOBA —

BANYANTREE.COM

# AWARDS & ACCOLADES

2015	Travel +Leisure USA Expedia Insiders' Select Travel +Leisure USA Earthcheck Silver Certified Rainforest Alliance Certified 96.89% Distintivo S Tourism Environmental Quality Earthcheck responsible Events Venue Seven Stars Luxury Hospitality & Lifestyle Award	"World's Best" Top 100 Hotels in the World The World's Best Hotels Latin America The World's Best Hotels Latin America Sustainability and Social Responsibility  Mexico Tourism Board PROFEPA  Spa Category
2014	Orbitz Condé Nast Traveller - Readers' Travel Awards Earthcheck Rainforest Alliance Conde Nast Traveller Best Hotels in Mexico – Top 10 Winners Travel + Leisure Hotel Awards Travel + Leisure World's Best Awards	Best In Stay Elite Riviera Maya Award One of the 20 best hotels of The Americas & Caribbean Sustainability and Social Responsibility Certification, Verification and Validation Services Gold List Issue: e BEST of the BEST in Travel US News Travel Report Number #1 Spa in Mexico Top 100 Hotels in the World
2013	Rainforest Alliance Trip Advisor Awards Condé Nast Traveller	Certification, Verification and Validation Services Top 10 listing for the World's Greatest Hotel Spas The Gold List
2012	Travelocity Expedia spAWARDS	Top Partners Insider's Select Top Spas in Mexico





BANYAN TREE  
— MAYAKOBA —

[BANYANTREE.COM](http://BANYANTREE.COM)

# BLISS POOL VILLA

## Floor Plan



# SERENITY POOL VILLA

## Floor Plan



# SPA POOL VILLA

## Floor Plan



Ground Floor



First Floor



# SERENITY TWO-BEDROOM POOL VILLA & TWO-BEDROOM POOL VILLA AT THE HAVEN Floor Plan



Ground Floor



First Floor

# OCEAN FRONT THREE-BEDROOM POOL VILLA AT THE HAVEN

## Floor Plan



Ground Floor



First Floor



# THREE-BEDROOM FAMILY RESIDENCE

## Floor Plan



Ground Floor

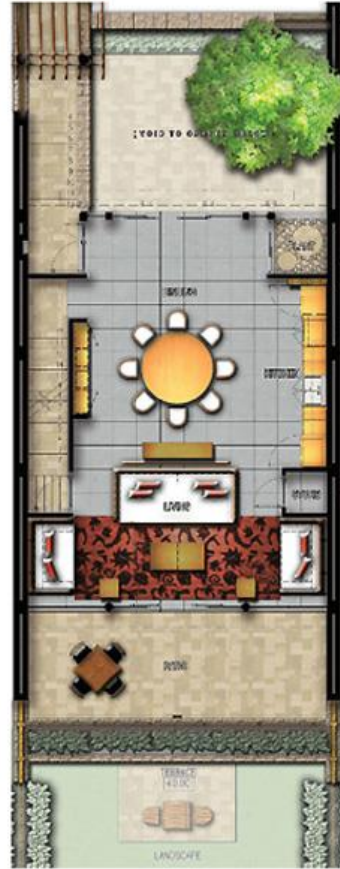

First Floor



Second Floor

