



FACTS AND INFORMATION

SHANGRI-LA HOTEL, PARIS



## SHANGRI-LA HOTELS AND RESORTS

Hong Kong-based Shangri-La Hotels and Resorts, one of the world's premier hotel companies, currently owns and/or manages more than 90 hotels under the Shangri-La brands with a room inventory of over 37,000.

With its name and philosophy inspired by the fictional paradise in James Hilton's 1930's novel "Lost Horizon", Shangri-La Hotels are internationally renowned for their very special "hospitality from the heart".

## HISTORY

In 1896, No. 10 avenue d'Iéna's "Palais" was the home of Prince Roland Bonaparte and the meeting place of Paris' aristocracy and bourgeoisie. 115 years later, restored by prominent architect Richard Martinet, this chic address once again welcomes the great people of the world as Shangri-La Hotel, Paris — the first Shangri-La Hotel to open in Europe. Listed as a Historical Monument since 2009, this exquisite hotel is a unique blend of Asian hospitality and French art de vivre.

## LOCATION

Shangri-La Hotel, Paris is centrally located in the 16th arrondissement of Paris, just minutes from the Place des Etats-Unis, the Place d'Iéna and the Place du Trocadero, on the Chaillot Hill, opposite the Eiffel Tower. The Triangle d'Or, the Champs-Elysees, and a myriad of luxury boutiques and museums are also just a stone's throw away.

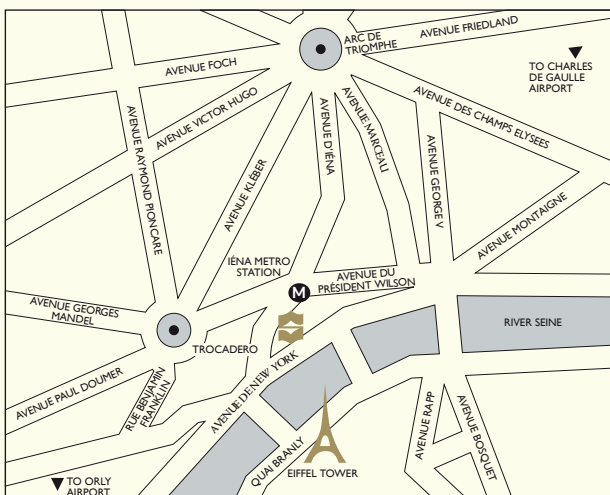

## ACCOMMODATION

Shangri-La Hotel, Paris offers 101 rooms including 36 suites. As with the rest of the hotel, Richard Martinet directed the architectural renovations and Pierre-Yves Rochon designed the interior style at times "Empire", at times "luxury minimalist", at times a stunning mix of both. Some of the rooms and suites have access to a balcony and offer stunning views of the city, the Eiffel Tower and the River Seine.

With a classical French style and elegant tones of blue, gold and cream, each room preserves the charm of a high-class private Parisian residence.

## SIGNATURE SUITES

### La Suite Chaillot

Located on the fifth floor, the stunning Suite Chaillot, named after the hill on which the hotel sits, boasts breathtaking views of the City of Lights. With a total of 110 m<sup>2</sup> of living space and a large 35 square metres corner terrace, this Suite is truly special.

### La Suite Shangri-La

Located on the seventh and top floor, La Suite Shangri-La is a peaceful haven stretching over 220 square metres including a private terrace of almost 100 square metres. The suite's modern architecture is balanced with classic French furnishings and elegant Asian touches and offers unparalleled views of the capital and beyond.

### La Suite Impériale

Originally Roland Bonaparte's 275 square metres private apartment, la Suite Impériale, located on the second floor, has an enchanting atmosphere due to its impressively high ceilings, tall windows and original ornate mouldings. It has a unique location, overlooking the Place d'Iéna and the magnificent George Washington statue, and also features state-of-the-art technology and facilities.

## RESTAURANTS AND BAR

Shangri-La Hotel, Paris offers an array choice of culinary experience where diversity and quality come together to satisfy the most discerning of palates. L'Abeille, an awarded Michelin star restaurant, overlooks a stunning "à la française" garden and offers classical French gourmet cuisine. Shang Palace, also a Michelin-starred restaurant, is home to authentic Cantonese cuisine. La Bauhinia, an airy and luminous restaurant, features French and Southeast Asian cuisine. Finally, Le Bar and the lounge's cosy atmosphere provide the perfect setting to relax.

Restaurants / Bar	Capacity	Cuisine
La Bauhinia	80	French and Southeast Asian contemporary cuisine
L'Abeille	40	Gourmet French restaurant, awarded Michelin star
Le Shang Palace	80	Traditional Chinese restaurant, awarded Michelin star
Bar and lounges	54	1 bar and 3 historic lounges which propose a tasty and voluntarily simple menu

## BANQUET AND CONFERENCE FACILITIES

Ideal for hosting a prestigious wedding, conference, seminar or banquet, Shangri-La Hotel, Paris' 850 square metres of reception areas and event spaces evoke the spirit of elegant events hosted by the Bonaparte family for 19th century Parisian society.

The four meetings and event spaces feature high ceilings, an abundance of natural daylight and state-of-the-art technology.

Venue	Capacity							Area m <sup>2</sup> /ft <sup>2</sup>	Ceiling Height m/ft
	Theatre	Banquet	Cocktail	Classroom	U-Shape	Oval table	Cabaret		
La Salle à Manger	90	90	100	56	40	32	56	100 / 1076	6.85 / 22.47
Le Grand Salon	130	110	180	90	52	48	64	140 / 1506	6.85 / 22.47
Le Salon de Famille	40	40	80	24	20	22	40	100 / 1076	6.85 / 22.47
Total Historical Meeting Rooms	•	270	500	•	•	•	•	520 / 5597	6.85 / 22.47
Le Salon Roland Bonaparte	270	200	310	147	54	38	144	250 / 2690	5.72 / 18.76



FLOOR 1

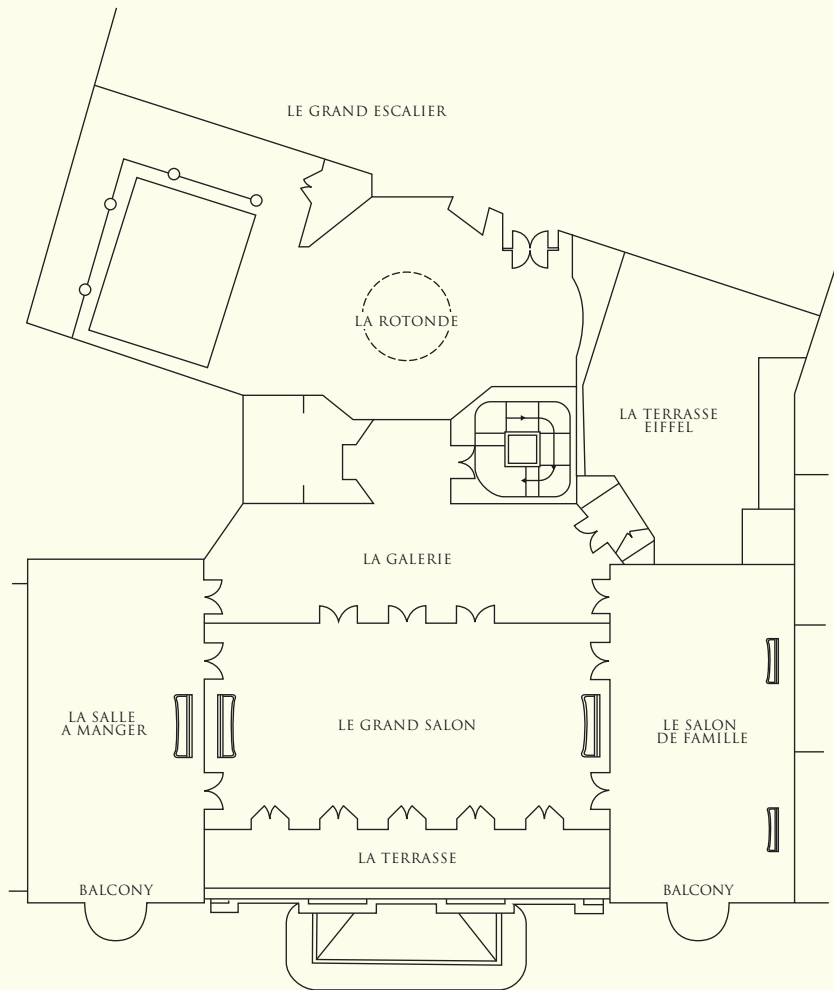

FLOOR FRESNEL 2

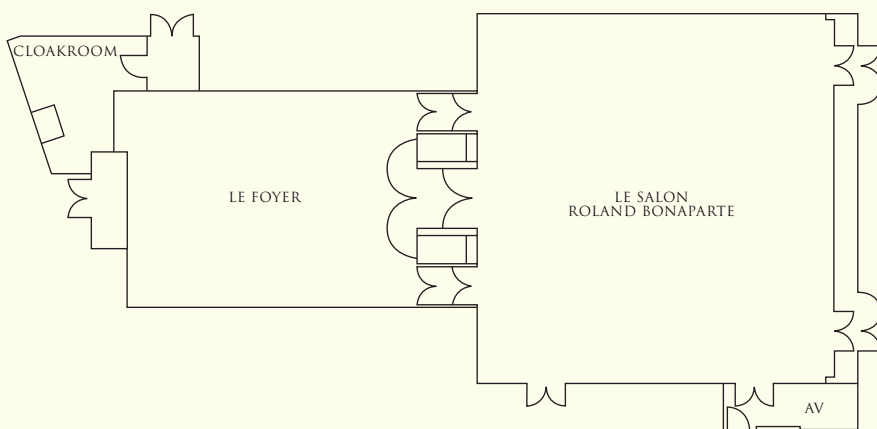

The 101 rooms and suites of Shangri-La Hotel, Paris, are grouped into 3 categories:

Categories	Rooms	Avg. Area (m <sup>2</sup> /ft <sup>2</sup> )
Rooms	65	
Superior	9	36 / 385
Deluxe	25	40 / 430
Premier	17	45 / 485
Eiffel Tower view	9	45 / 485
Terrace Eiffel Tower view	5	50 / 535
Suites	33	
Deluxe	11	60 / 645
Duplex	5	80 / 860
Eiffel Suite with partial view	5	60 / 645
Terrace	6	70 / 750
Duplex Eiffel Tower view	3	70 / 750
Duplex Terrace Eiffel Tower view	2	70 / 750
Terrace Eiffel Tower view	1	70 / 750
Signature Suites	3	
La Suite Chaillot	1	110 / 1,175
La Suite Shangri-La	1	120 / 1,290
La Suite Impériale	1	275 / 2,960
Total number of twin size bedrooms	34	•
Total with reduced mobility access	4	•

#### GUESTROOM FEATURES

- Twice-daily housekeeping service
- Pillow menu on request
- Complimentary high-speed Internet access
- Espresso coffee machine
- In-room safe
- Interactive flatscreen television
- Iron and ironing board on request

#### BATHROOM FEATURES

- Separate bathtub and walk-in shower
- Luxurious bathroom amenities
- Television in the mirrors
- Marble heated floors

#### FUNCTION ROOM HIGHLIGHTS

- Four function rooms
- Daylight in all reception rooms
- Accessible 24/7
- Single contact person
- Complimentary high-speed Internet access
- Consulting services for specific events such as weddings or fashion shows

#### CHI, THE SPA

- Two treatment rooms
- In-room spa treatments
- Outdoor terrace (open during spring and summer season mainly)
- 15-metre long swimming pool with natural daylight
- 24-hour fitness center
- Personal trainer on request

#### OTHER SERVICES AND FACILITIES

- Concierge
- 24-hour in-room dining
- 24-hour laundry / dry-cleaning / pressing
- Complimentary shoeshine service
- Services and amenities for younger guests
- Umbrellas
- Valet parking
- Business center
- Car rental
- Reduced mobility access
- Non-smoking property
- Taxi and limousine service

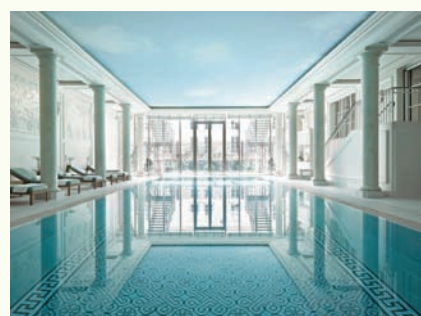

**SHANGRI-LA**

**HOTELS *and* RESORTS**

Shangri-La Hotel, Paris